

Aputure®

MAGNUM

"魔光"电子闪光灯

**SPEEDLITE
MG-68TL**



User Manual
使用者指南

Aputure®
www.aputure.com

Aputure Manufacturing Authority

目 录

安全须知	1
前言	2
产品功能简介	3
主要特点	3
各部件名称	4
机身各部件名称	5
操作面板各部件名称	5
用前准备及操作	5
电池安装	5
安装及取下闪光灯	5
开启及关闭电源	6
测试闪光	6
闪光灯充电	6
节电模式	6
功能与操作	7
高级应用	9
技术参数	12
重要注意事项	13
常见问题	13

安全须知

为了防止对产品造成损害或伤害到您自己或他人，请在使用前充分阅读下面的安全须知，并妥善保管以便所有本产品使用者可随时参阅。

🔧 请勿自行拆卸或改装

违反此警告可能会触电或导致产品故障。若本产品因为掉落或其它意外事故造成破损，请取出电池，并送到专业维修店维修。

🔧 保持干燥

- 请勿用湿手操作，禁止将产品置于水中或在雨中作业。否则可能引起火灾或触电。
- 请勿在有易燃气体的环境下使用，否则可能引起爆炸或火灾。

🔧 置于儿童接触不到的地方

本产品包含的零部件，有可能造成窒息的危险。如果儿童不小心吞食了零件，请立即送往医院救治。

🔧 使用闪光安全事项

请勿对人体的眼睛或需要高度注意力的人使用闪光灯，否则可能引发安全事故。

🔧 电池使用安全事项

- 只能使用本手册中指定的电池。不要混用新旧电池或不同类型的电池。
- 请勿拆卸电池或使电池短路。
- 装电池时要注意正负极对应正确。
- 当长期不使用本产品时请将电池取出。

前言

衷心感谢您惠购爱图仕电子闪光灯，“魔光”电子闪光灯MG-68TL功能强大，具有TTL自动闪光，精细的亮度调节等功能，满足您更高的布光需求。在使用本产品之前，请仔细阅读使用说明，了解其特性，以便充分发挥产品的各项功能。



产品功能简介

爱图仕“魔光”电子闪光灯MG-68TL功能强大，是摄影中不可多得的利器。MG-68TL全功率回电仅需4秒，连接外置电源后，回电可缩短至2秒；精细的亮度调节；兼容TTL自动闪光；5种工作模式支持各种闪光环境；光感应灵敏度；可自动进入节电和过热保护模式，并且具有PC同步口。使用MG-68TL闪光灯，开始您更美妙的闪光体验。

主要特点：

- | | |
|--------------------------------|--------------|
| 1. TTL自动闪光 | 6. 具有PC同步口 |
| 2. 五种工作模式
(TTL/M/III/S1/S2) | 7. 外置电源插座 |
| 3. 精细的亮度调节 | 8. 节电模式 |
| 4. 光学触发感应器 | 9. 记忆功能 |
| 5. 高速回电 | 10. 过热保护 |
| | 11. LCD高清显示屏 |

各部件名称

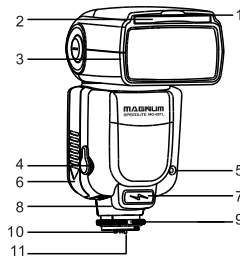

机身

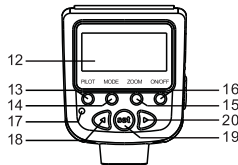

操作面板

机身各部件名称：

1. 反射板
2. 广角扩散板
3. 闪光灯头
4. PC孔
5. 光学触发感应器
6. 电池仓盖
7. 外置电源插座
8. 热靴座
9. 固定旋钮
10. 热靴触点
11. 固定针

操作面板各部件名称：

12. 液晶显示屏
13. 测试按键<PILOT>
14. 模式切换按键<MODE>
15. 灯头变焦按键<ZOOM>
16. 电源开关按键<ON/OFF>
17. 充电指示灯
18. 功率和焦距调节按键(减小)
19. 功率微调键<SET>
20. 功率和焦距调节按键(增大)

用前准备及操作

电池安装

1. 按箭头所示方向滑动电池仓盖将其打开。
2. 按电池盖的正负极指示安装电池，确保电池的正负触点朝向正确。
3. 按箭头所示方向滑动电池仓盖将其关闭。



安装及取下闪光灯

1. 按箭头所示方向转动固定旋钮到最高点。
2. 将闪光灯热靴座完全推入相机热靴。
3. 按箭头所示方向转动固定旋钮拧紧。
4. 取下闪光灯时，请松开固定旋钮，然后从相机热靴中推出。

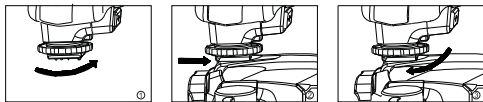

开启及关闭电源

1. 长按 <ON/OFF> 键2秒可打开闪光灯电源。
2. 使用完毕后，长按 <ON/OFF> 键2秒即可关闭电源。

❏ 小贴士：

若要取出电池，请先关闭电源。

测试闪光

无论处在哪种模式下，您都可以通过按 <PILOT> 按键来测试闪光灯是否闪光正常。测试闪光时，闪光灯会按照所选择的输出功率的等级发出相应亮度的闪光。

闪光灯充电

超速回电

MG-68TL 闪光灯正常约4秒全功率回电，您可购买爱图仕AP-EBN外置充电盒，将其连接至闪光灯的充电口和PC同步口，闪光之后，充电盒将对闪光灯进行充电，回电时间将缩短为2秒。

❏ 小贴士：

闪光灯与外置充电盒连接后，手按 <PILOT> 不能缩短回电时间，只有当闪光灯安装在相机或引闪器上，通过热靴引闪时，才能缩短回电时间。

<充电指示灯> 状态含义：

<充电指示灯>状态	含义	处理方法
亮绿灯	充电已完成	正常
亮红灯	在充电	正常
绿灯闪	因频繁闪光激发过热保护	将闪光灯静置2分钟，冷却后可继续拍摄
红灯闪	电池电量不足或一次充电时间超过20秒	关机换电池或再次开机

节电模式

50秒后无任何操作，MG-68TL闪光灯进入节电模式，可以通过本闪光灯任意按键唤醒。

功能与操作

五种工作模式

按<Mode>键, MG-68TL将进入模式切换状态, 每按一次, 闪光灯将在TTL/M/频/S1/S2/五种工作模式之间循环切换。选择模式后, 您可以根据自己的喜好设定参数, 通过<◀>与<▶>按键可以对曝光指数或闪光亮度等进行调节(无论在何种工作模式下, 按2秒以上可快速快进设置参数)。其中M/S1/S2的闪光亮度的调整范围是1/128-1/1, 亮度共8档, 每档还有3级微调功能。

TTL模式

将相机的拍摄模式设置为<M><AV><TV>时, MG-68TL闪光灯通过相机镜头测光进行自动闪光。

1. 通过<◀>与<▶>调节曝光指数, 每按一次在-3至3范围内以1/3减小或增加曝光指数。



2. 设定曝光指数后, 半按快门按键进行对焦。

3. 闪光灯与相机通讯并显示相机的光圈值和镜头焦距值, 此时闪光灯将自动变焦, 与相机的焦距值一致。

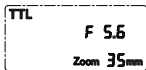

4. 全按相机快门键拍照, 闪光灯自动进行闪光。

M模式

在M模式下拍摄时, 您只需要设定闪光亮度, 调整相机并按下快门, 闪光灯会在相机同步信号下进行闪光。

频闪(频)模式

在频闪模式下, 闪光灯可以在拍摄照片时发出一系列快速的闪光对移动的物体进行多个图像的拍摄。您可以设置闪光亮度、闪光频率、和闪光次数。

1. 调节闪光亮度

通过<◀>与<▶>按键, 闪光亮度具有1/128, 1/64, 1/32, 1/16, 1/8, 1/4 共6档调节。

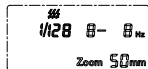

2. 设定频率

当按下SET键时, 出现"8 Hz"闪烁, 这时可通过<◀>与<▶>按键对频率进行调节, 频率的可调范围为1-90, 当确认参数后, 按"SET"可保存参数并退出, 或闪光灯会在10秒后自动保存参数并退出。

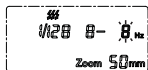

3. 设定频闪次数

当设定好频率的数值后, 按<SET>键可出现"8-"闪烁, 这时可对频闪的次数进行调节, 频闪次数的可调范围为1-50, 当确认参数后, 按"SET"可保存参数并退出, 或闪光灯会在10秒后自动保存参数并退出。

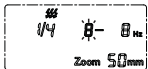

S1模式

在S1模式下, 作为离机副灯使用, MG-68TL闪光灯适用于手动闪光灯环境, 光学触发感应器需对着主闪光灯。当主闪光灯第一次闪光时可同步触发其闪光。

小贴士：

在S1模式下，主闪光灯不应使用具有预闪的TTL闪光系统，也不应使用具有多次闪光的红眼减轻功能。

S2模式

在S2模式下，作为离机副灯使用，MG-68TL 闪光灯支持TTL闪光环境，光学触发感应器需对着主闪光灯。MG-68TL在S2模式下，能忽略预闪，与主闪灯或内置闪光灯同步闪光。

手动灯头变焦

无论在何种模式下，都可通过<ZOOM>按键可以手动设置灯头的变焦位置。按下<◀>与<▶>按键，闪光灯灯头焦距将在(24/28/35/50/70/80/105mm)之间切换，再次按<ZOOM>键时确认及保存当前设置。

记忆功能

MG-68TL闪光灯再次开机会自动保存上一次的模式和参数设定。再次使用时无需重复设定，提高您的拍摄效率。

PC同步口

通过连接PC同步口，可以使闪光灯同步闪光。搭配爱图仕“引闪大师”使用，可达相机的最高同步速度。

过热保护

连续拍摄过于频繁时，将触发MG-68TL闪光灯的过热保护机制，此时指示灯将绿灯闪烁，将闪光灯静置2分钟后可继续拍摄。

小贴士：

为避免影响拍摄，需要快速拍摄时，请尽量使用1/4及以下输出。

高级应用

多灯布光

使用内置闪光灯或机顶外置闪光灯作为主灯，将多个闪光灯作各种不同的方向摆放，光感应灵敏度。高。

1. 在室内使用时，光信号可通过墙壁反射回来，因此在放置副闪时可以有更多空间，光感应距离为20-30米。
2. 户外状态，光感应距离为10-15米。室外使用时请注意，光学触发感应器需要对着主控闪光灯，且不能让阳光直接照射，可通过上下左右调整MG-68TL闪光灯的角度来调节光照的方向，满足您各种拍摄的需求。

小贴士：

1. 放置副MG-68TL闪光灯作为离机副闪光灯使用时，请在拍摄前先测试S1或S2模式是否正常同步。
2. 请勿在主闪光灯及副闪光灯之间放置障碍物，避免障碍物阻碍光学信号传递。

反射闪光

反射闪光，即跳闪，是指通过闪光灯头指向墙壁或天花板，借助天花板或墙壁反射回来的光照亮物体进行拍摄，创造出柔光箱一样的照明效果。这样可以减轻被摄物体背后阴影，甚至可以用闪光灯创造出大面积光线，获得更自然的摄影效果。如果墙壁或天花板太远，反射闪光可能太弱导致曝光不足，白色平坦的墙壁或天花板有利于高效的反射，并避免产生偏色。

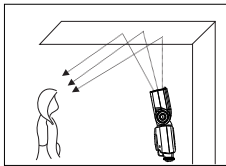

利用反射板拍摄

使用反射板闪光，把反射板和广角扩散板从灯头一起拉出，将广角扩散板推回。如果此时进行拍摄，可以在主体的眼睛造成高光点，即眼神光，使眼神更加迷人有光彩。此功能在闪光灯灯头上仰90度时能达到最好的效果。

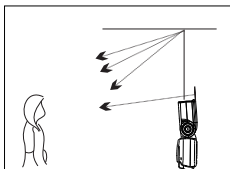

使用广角扩散板

拉出广角扩散板推回反射板，并按图示摆放，闪光范围将会扩大，同时闪光效果将更加柔和自然。

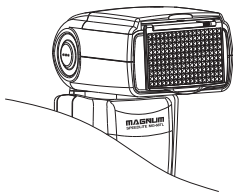

技术参数

线路设计:	自动绝缘两级晶体 (IGBT)
闪光指数:	48(105毫米焦距, ISO 100, 以米为单位)
闪光模式:	TTL/M/SS/S1/S2
无线触发距离:	室内20-25米, 室外10-15米
上下旋转角度:	0-90度
左右旋转角度:	0-270度
电源:	4枚AA碱性电池或AA镍氢 (Ni-MH) 电池
发光次数:	100-1500次 (使用AA碱性电池)
回电时间:	约4秒 (使用AA碱性电池)
色温:	5600K
闪光灯时间:	1/200-1/20000秒
闪光控制:	1/128-1/1 (共22级微调)
外部接口:	热靴, PC同步口、外置电源插座
附加功能:	曝光补偿、曝光包围、灯头手动变焦、自动变焦、PC同步
体积:	190X60X78毫米(伸展状态)
净重:	350克
所含物品:	闪光灯(1), 保护袋(1), 微型底座(1), 说明书(1), 保修卡(1)

重要注意事项

1. 户外使用时，请防止太阳光直射闪光灯的光学触发感应器，确保闪光灯能够正常使用。
2. 户外使用柔光伞应注意当闪光灯安装柔光伞时，请固定安装架，避免被风吹倒，导致闪光灯热靴脚摔断。

常见问题

1. 在使用过程中，如果闪光灯不能启动？

- 确保电池的正负极安装正确（请参照P5页）。
- 更换一组新电池后再重启。
- 将闪光灯的安裝插脚稳固安装于相机上。
- 确保闪光灯及相机的热靴接触点干净。

2. 闪光灯功能异常？

请试图关闭闪光灯与相机的电源，在相机热靴上安装好闪光灯后，再重新打开闪光灯与相机电源。如仍有异常，请更换一组新电池再尝试使用。

3. 照片欠曝或过曝？

检查此时照相机设置的快门、光圈、感光度（ISO）是否过于接近闪光的极限，或者相机曝光补偿、曝光包围等与闪光有关的设置是否正确。

4. 相片出现暗角或者被摄物体只有局部能照亮？

请检查闪光灯当前的覆盖焦距。请检查镜头焦距是否超出闪光灯的覆盖范围，闪光灯设计的灯头变焦范围中画幅系统的24-105mm，您可以尝试拉出广角扩散板，以扩大闪光范围。

MAGNUM

SPEEDLITE MG-68TL



User Manual

Index

Safety Notice	1
Foreword	2
Product Introduction	3
Main Features	3
Components	4
Flash	4
Control Panel	4
Getting Started and Basic Operation	5
Battery Installation	5
Attaching/Detaching Flash	5
Power On/Off	5
Flash Testing	6
External Power	6
Power Saving	6
Function and Operation	7
Extra Functions	10
Specifications	12
Important Notice	13
Troubleshooting	13

Safety Notice

To prevent damage to your product or injury to yourself or to others, read the following safety precautions in their entirety before using this equipment. Keep these safety instructions where all those who use this equipment will read them.

 **Do not disassemble or modify**

Failure to observe this precaution could result in electric shock or product malfunction. If the product break open as the result of a fall or other accident, remove the batteries.

 **Keep dry**

- Do not handle with wet hands or immerse in or expose to water or rain. Or it maybe result in fire or electric shock.
- Do not use in the presence of flammable gas. Or it could result in explosion or fire.

 **Keep out of reach of children**

This device contains small parts which may pose a choking hazard. Consult a physician immediately if a child swallows any part of this device.

 **Safe to flash**

Do not flash near the eyes or flash directly towards people who are working, as it may cause an accident.

 **Observe precaution when handling batteries**

- Use batteries listed in this manual. Do not mix old and new batteries or batteries of different types.
- Do not short or disassemble.
- Do not attempt to insert batteries upside down or backwards.
- Remove the batteries when leaving MG-68TL unattended for prolonged periods.

Foreword

Thanks for purchasing Aputure Magnum Speedlite (MG-68TL). We are excited to join the flash gun market with our new speedlites. They come packed with great features, including TTL control, precise brightness adjustment, and more-optimized for stellar flash photography. For the best results, read this user guide carefully.



Product Introduction

Aputure Magnum Speedlite (MG-68TL) is an exciting new flash gun with a variety of features. It has TTL control, 4 sec recycle time, an external power port enabling 2 sec recycle, precise brightness control, 5 flash modes, optical slave sensor, power saving mode, PC sync port, and more. Whatever your flash lighting needs, take aim with the Aputure Magnum Speedlite and gun'em down.

Main Features

1. TTL Control
2. 5 Flash Modes
(TTL/M/SS/S1/S2)
3. Precise Brightness Adjustment
4. Optical Sensor
5. Fast Recycling
6. PC Sync Port
7. External Power Port
8. Power Saving Mode
9. Settings Recall
10. Overheating Protection
11. Detailed LCD Display

Components

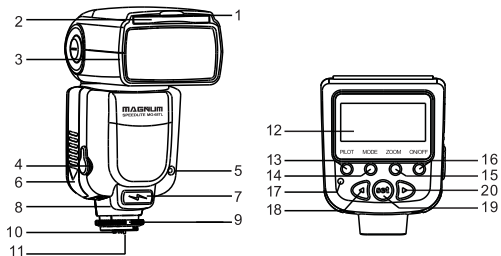

Flash

1. Catchlight Panel
2. Wide Panel
3. Flash Head
4. PC Sync Port
5. Optical Sensor
6. Battery Cover
7. External Power Port
8. Hot Shoe Mount
9. Locking Nut
10. Hot Shoe Contacts
11. Locking Pin

Control Panel

12. LCD Screen
13. Test Button <PILOT>
14. Mode Switch Button<MODE>
15. Zoom Button<ZOOM>
16. Power Switch <ON/OFF>
17. Charge Indicator Light
18. Brightness/Zoom Adjustment Button(Decrease)
19. Fine-tuning Button <SET>
20. Brightness/Zoom Adjustment Button (Increase)

Getting Started and Basic Operation

Battery Installation

1. Slide the battery cover as shown by the arrow and open it.
2. Make sure the + and – battery contacts are correctly oriented as shown in the battery compartment.
3. Close the battery cover and slide it as shown by the arrow.



Attaching/Detaching Flash

1. Rotate the speedlite's locking nut to the highest position.
2. Slide the speedlite's mounting foot into the camera's hot shoe.
3. Rotate the locking nut until tightly fixed.
4. To detach the speedlite, loosen the locking nut and slide out of the hot shoe mount.

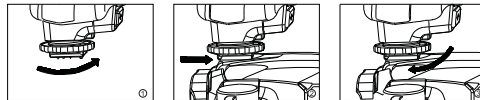

Power On/Off

1. Long press <ON/OFF> for 2 seconds to turn power on.
2. Long press <ON/OFF> for 2 seconds to turn power off.

ⓘ Note: Turn off before removing batteries.

Flash Testing

Press <PILOT> to fire a test MG-68TL in any mode, and it will flash in accordance with the output brightness power you have set.

External Power

Lighting speed flash recycling

MG-68TL normally recycles to full power in 4 seconds. But when connecting to an external power source, such as Aputure's external battery adaptor (AP-EBN), it can recycle to full power in only 2 seconds.

- Note: 1. Connect with external power source using PC-sync port and external power port
- 2. After connecting with external battery adapter, MG-68TL only takes 2 seconds to recycle when triggered directly by the camera or Trigmaster. However, this doesn't apply when pressing <PILOT> to fire the flash.

Indicator lights

Indicator State	Meaning	Solution
Light green	Fully charged, ready to flash	Normal
Light red	Still charging	Normal
Blink green	Under protection due to frequent flashing, unable to flash	Wait about 2 minutes until light stops blinking
Blink red	Still charging for more than 20 seconds, not enough power	Replace the batteries or restart MG-68TL

Power Saving

MG-68TL will enter power saving mode when idle for 50 seconds. You can wake up the flash by pressing any button.

Function and Operation

5 Flash Modes

Press <Mode> to switch modes between TTL/M/III/S1/S2. Once the mode has been set, adjust the exposure, brightness or other parameters by pressing <◀> and <▶>. If pressing for more than 2 sec in any mode, settings will continue adjusting. When in M/S1/S2 mode, brightness can be set among 8 levels, from 1/128 to 1/1 power. What's more, each level includes 1/3 stop adjustments for fine tuning.

TTL mode

MG-68TL can flash in TTL mode. The camera should be set to <M> <AV><TV>.

1. Press <◀> and <▶> to adjust the exposure from -3 to +3 in 1/3rd stop.



2. Half press the shutter button to focus.
3. MG-68TL will display the aperture value and focal length on the LCD screen. ZOOM will be set automatically according to the lens & focal length being used.



4. Fully press the shutter button to take a photo utilizing TTL flash.

M mode

Press <Mode> to enter M mode. While on the camera hot shoe, MG-68TL will flash when you press the camera shutter.

Strobeflash(☘) Mode

In this mode, MG-68TL fires rapidly to capture multiple exposures of fast moving subjects in a single image. You can adjust the brightness output, frequency and flash number as needed.

1. Brightness Adjustment

Press <◀> and <▶> to adjust the brightness among 1/128, 1/64, 1/32, 1/16, 1/8 and 1/4.



2. Frequency Adjustment

The default frequency is "8 Hz". Press <◀> and <▶> to adjust the frequency from 1hz to 90hz. Save by pressing <SET> button or it will automatically save it in 10 seconds.

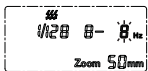

3. Flash Number Adjustment

Press <SET> button again to adjust the number of flashes fired. The default is "8—" as shown in the picture. Adjust the flash times from 1 to 50. Save by pressing <SET> button or it will automatically save it in 10 seconds.

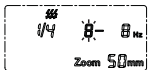

S1 mode

When in S1 mode, MG-68TL can work as an off-camera auxiliary flash while using your master flash in manual mode. When the master flash fires, it will trigger MG-68TL, as long as it's facing the built-in optical sensor.

Note: For best results, disable pre-flash function and red-eye reduction.

S2 mode

When in S2 mode, MG-68TL can also work as an off-camera auxiliary flash while shooting your master flash in TTL mode. MG-68TL will ignore the pre-flash of the master flash. When the master flash fires, it will trigger MG-68TL, as long as it's facing the built-in optical sensor.

Manual Flash Coverage (ZOOM)

You can manually set flash coverage by pressing <ZOOM> button. You can adjust the zoom by pressing <◀> and <▶>. The flash coverage can be set to match the lens focal length from 24mm to 105mm. Save by pressing <ZOOM> button again.

Settings Recall

MG-68TL saves the parameters/settings last used when powering off and back on again. There's no need to remember and set everything all over again.

PC Sync Port

MG-68TL can work when using the PC sync port. It can flash at the camera's maximum flash sync speed if triggered by Trigmaster.

Overheating Protection

The MG-68TL will enter protection mode when it flashes too frequently. It will blink green. Wait about 2 minutes until light stops blinking to continue your work.

Note: The output brightness should be set below 1/4 power to keep flashing continuously.

Extra Functions

Multi-Flash Lighting

Use the camera's built-in flash or another speedlite as a master flash. As an optical slave, MG-68TL can be triggered remotely as an auxiliary flash.

1. Indoors, MG-68TL can be triggered up to 20-30m. The optical sensor can be triggered by bounced flash light reflected off walls, or by direct flash light.
2. Outdoors, MG-68TL can be triggered up to 10-15m. The optical sensor should face the master flash, and protect it away from direct sunlight.

- ⓘ Note: 1. Test the sync function in S1/S2 mode before using as an auxiliary flash.
2. For reliable triggering, keep nothing between MG-68TL and master flash.

Bounce Flash

Aim the flash head at a wall or ceiling and use the reflected light to illuminate the desired object. This can soften shadows, resulting in more natural lighting.

If the wall or ceiling is too far, bounce flash maybe too weak. The wall or ceiling should be flat and white in order to get effective reflection. If the reflection surface is not white, color cast may appear in the photo.

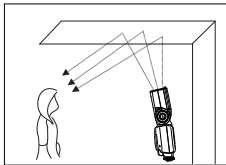

Catchlight Panel

Pull the catchlight and wide panels out from the flash head and then push the wide panel back. With the reflector, MG-68TL will produce a highlighted point on the eyes of the subject. When the flash head is up to 90°, the catchlight panel works best.

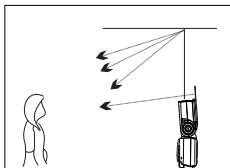

Wide Panel

Pull out the wide and catchlight panels out from the flash head and then push the catchlight panel back. With the wide panel, the flash scope will extend, and the lighting effect will be softer and more natural.

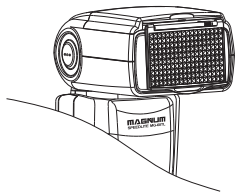

Specifications

Circuit design:	IGBT
Guide number:	48 (at 105mm focal length, ISO 100 in meters)
Flash modes:	TTL/M/☘/S1/S2
Wireless coverage:	20-25m indoors, 10-15m outdoor
Vertical rotation angle:	0-90 degrees
Horizontal rotation:	0-270 degrees
Power:	4 AA batteries (Alkaline or Ni-MH)
Flash cycles:	100-1, 500 times (Alkaline batteries)
Flash recycling:	About 4 seconds(Alkaline batteries)
Color temperature:	5600k
Flash time:	1/200-1/20000s
Brightness:	8 levels from 1/128 to 1/1 (+ 1/3rd stop intervals)
Port:	Hot shoe, pc port, external power port
Assited functions:	Exposure compensation, exposure bracketing, ZOOM adjustment (manual or automatic), PC sync
Dimensions:	190x60x78mm
Net weight:	350g
Packing list:	Speedlite(1), protective cover (1), mini stand (1), user manual (1), warranty card (1)

Important Notice

- 1.To ensure MG-68TL work efficiently outdoor, keep the optical sensor out from the direct sunlight.
- 2.To avoid the damaging of MG-68TL when using the diffusion umbrella outdoors, secure the flash tightly with mounting bracket.

Troubleshooting

- 1.Speedlite doesn't fire.
 - Make sure the batteries are installed in the correct orientation.
 - Replace the batteries with new ones.
 - Attach the speedlite's mounting foot securely to the camera hot shoe mount.
 - Clean the contacts on the mounting foot.
- 2.Speedlite works abnormally.

Switch off the power of the speedlite and camera, mount the speedlite on the hot shoe of camera, and switch on the power of both units. If the abnormality continues, replace the batteries.
- 3.Flash exposure is underexposed or overexposed.

Check the shutter speed, aperture, ISO, EC, and readjust accordingly to balance properly with the flash exposure.
- 4.Vignetting appears in photos or only part of the subject is illuminated.

Check the focal length of your lens and make sure it doesn't exceed the coverage range of MG-68TL (24 to 105mm). Try pulling out the wide panel to expand the flash scope.

(The instructions and information in this manual are based on strict, controlled company testing procedures. Further notice will not be given if the design and specifications change.)